

NOTES: UNLESS OTHERWISE SPECIFIED

1. ABBREVIATION USED IN TITLE IS: VALVE REGULATED SEALED LEAD ACID (VRSLA).

2. BATTERY CONFORMS TO THE DESIGN REQUIREMENTS OF 14 CFR PARTS 23.1353, 25.1353(c), 27.1353, 29.1353(c).

3. INSPECT PER FAR 21.303(h) QUALITY SYSTEM.

4. "L" SUFFIX DENOTES A "FIRE RESISTANT" EXTERNAL CONTAINER CONSTRUCTED OF 5052 ALUMINUM ALLOY. "LS" SUFFIX DENOTES A "FIRE PROOF" EXTERNAL CONTAINER CONSTRUCTED OF STAINLESS STEEL.
5. SEE DRAWING NUMBER CB-00224 AND PROCEDURE P-1000 FOR ASSEMBLY AND TEST INSTRUCTIONS. PROCEDURES AND ASSEMBLY DRAWINGS ARE FOR INTERNAL USE ONLY.

6. BATTERIES ARE RATED IAW INTERNATIONAL ELECTROTECHNICAL COMMISSION STANDARD 60952-1 AND RTCA STANDARD D0-293, UNLESS OTHERWISE NOTED.

7. DIMENSIONS ARE IN INCH [MILLIMETER].

8. BATTERY MAY BE FITTED WITH CONCORDE TS-XX SERIES TEMPERATURE SENSOR.

REVISIONS			
REV	DESCRIPTION	DATE	APPROVED
B	REDRAWN & REISSUED FOR TSO	5/22/08	JBT

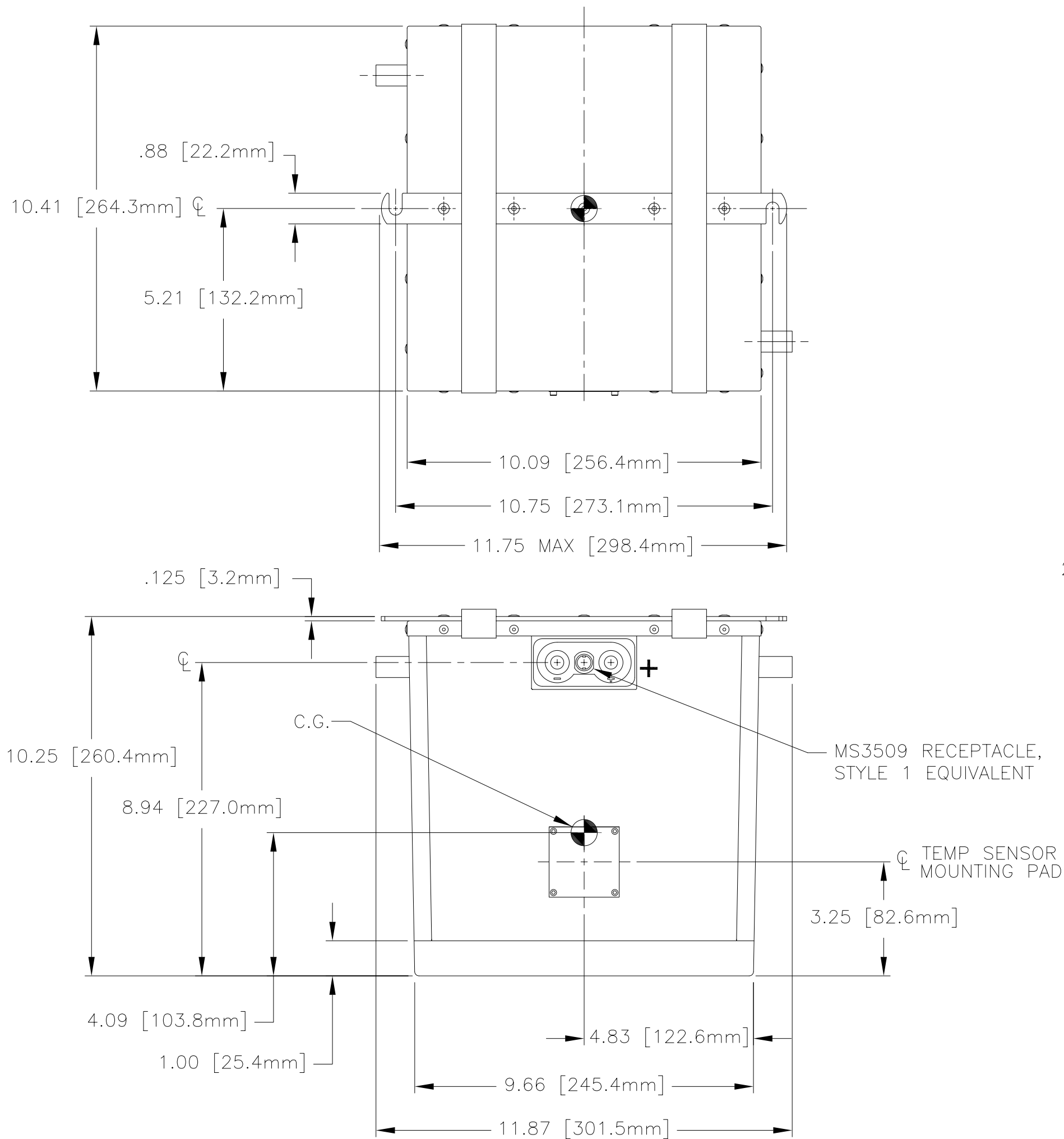

PART NUMBER	RG-380E/40L	RG-380E/40LS
MAXIMUM WEIGHT	84 LBS [38.1 KG]	86 LBS [39.0 KG]
RATED CAPACITY, C <sub>1</sub>	38 AH	
POWER RATING AT 23°C	I <sub>pp</sub> 1350A, I <sub>pr</sub> 1050A	
POWER RATING AT -18°C	I <sub>pp</sub> 900A, I <sub>pr</sub> 750A	
POWER RATING AT -30°C	I <sub>pp</sub> 650A, I <sub>pr</sub> 550A	

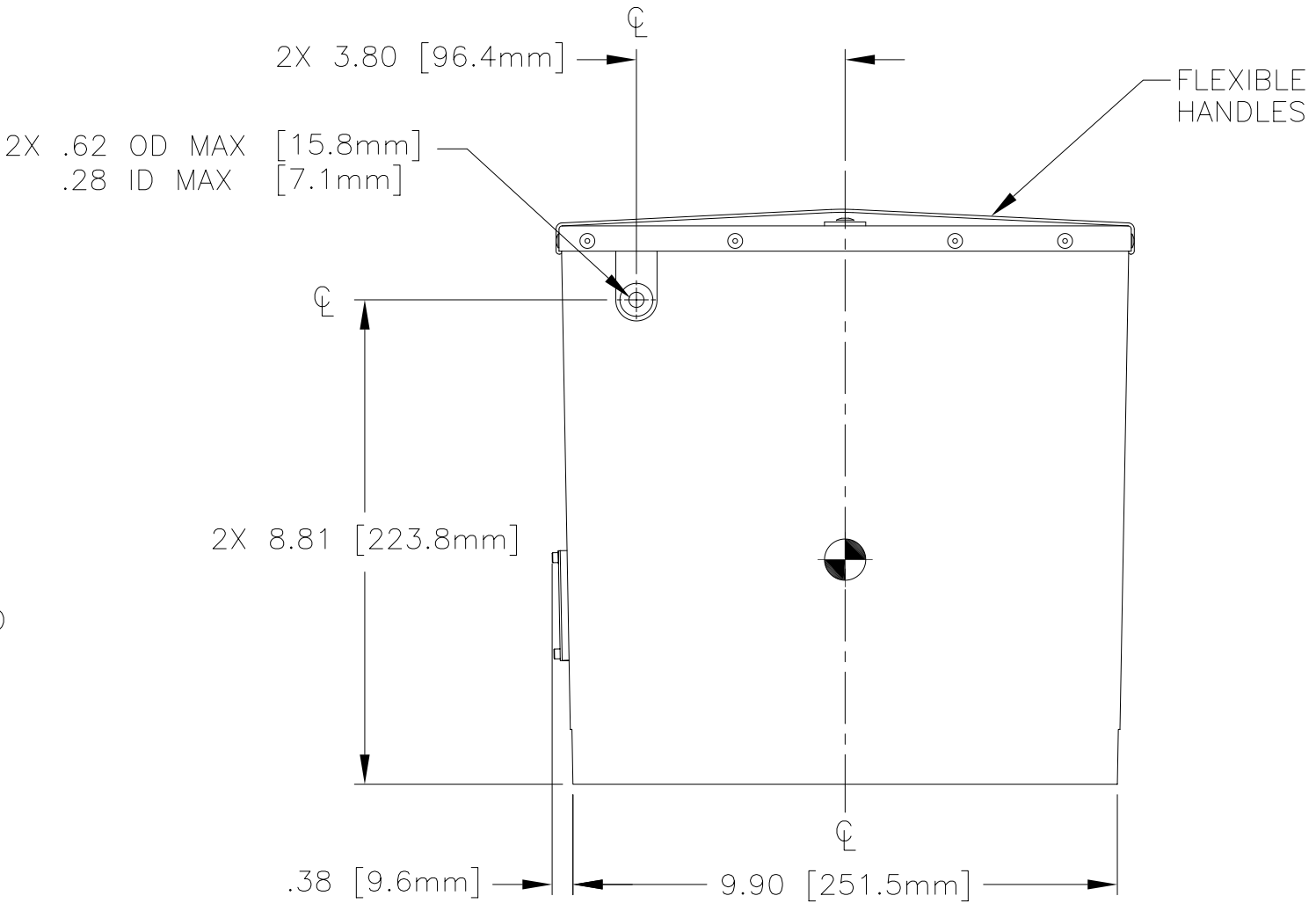

ENVELOPE DRAWING

QTY REQD	CAGE CODE	PART OR IDENTIFYING NO.	NOMENCLATURE OR DESCRIPTION	MATERIAL SPECIFICATION	ITEM NO.
PARTS LIST					
UNLESS OTHERWISE SPECIFIED DIMENSIONS ARE IN INCHES TOLERANCES ARE: FRACTIONS DECIMALS ANGLES ± 1/32" .XX ± .06 ± 1° .XXX ± .030			CONTRACT NO.	CONCORDE BATTERY CORPORATION 2009 SAN BERNARDINO RD, W. COVINA, CA 91790	
TREATMENT NONE			APPROVALS	DATE	TITLE
FINISH NONE			DRAWN A. MISTRETTA	5/15/08	BATTERY, VRSLA, 24 VOLT, RG-380E/40L(S) SERIES
SIMILAR TO			CHECKED AMIII	5/22/08	SIZE C
ACT WT			APPROVED JBT	5/22/08	CAGE CODE 63017
CALC WT			ISSUED NS	5/23/08	DWG NO. RG-380E/40L
			SCALE NONE		REV B
			SHEET 1 OF 1		