

NOTES: UNLESS OTHERWISE SPECIFIED

- BATTERY CONFORMS TO THE DESIGN REQUIREMENTS OF 14 CFR PARTS 23.1353, 25.1353(c), 27.1353, 29.1353(c).
- MANUFACTURED AND INSPECTED IAW AS9100 QUALITY SYSTEM REQUIREMENTS.
- ABBREVIATION USED IN TITLE IS: VALVE REGULATED SEALED LEAD ACID (VRSLA).
- SEE DRAWING CB-00222 AND PROCEDURE P-1000 FOR ASSEMBLY AND TEST INSTRUCTION. PROCEDURES AND ASSEMBLY DRAWINGS ARE FOR INTERNAL USE ONLY.
- BATTERIES ARE RATED IAW INTERNATIONAL ELECTROTECHNICAL COMMISSION STANDARD 60952-1 AND RTCA DO-293, UNLESS OTHERWISE NOTED.
- DIMENSIONS ARE IN INCH [MILLIMETERS].

REVISIONS			
REV	DESCRIPTION	DATE	APPROVED
A	PRODUCTION RELEASE	1/26/95	DG
B	SEE DCN 0036	6/23/95	DG
C	SEE DCN 0157	3/6/97	DG
D	ADDED C.G.	5/10/05	JBT
E	UPDATED NOTES 2, 5, AND RATINGS PER TSO TEST	11/06/09	JBT

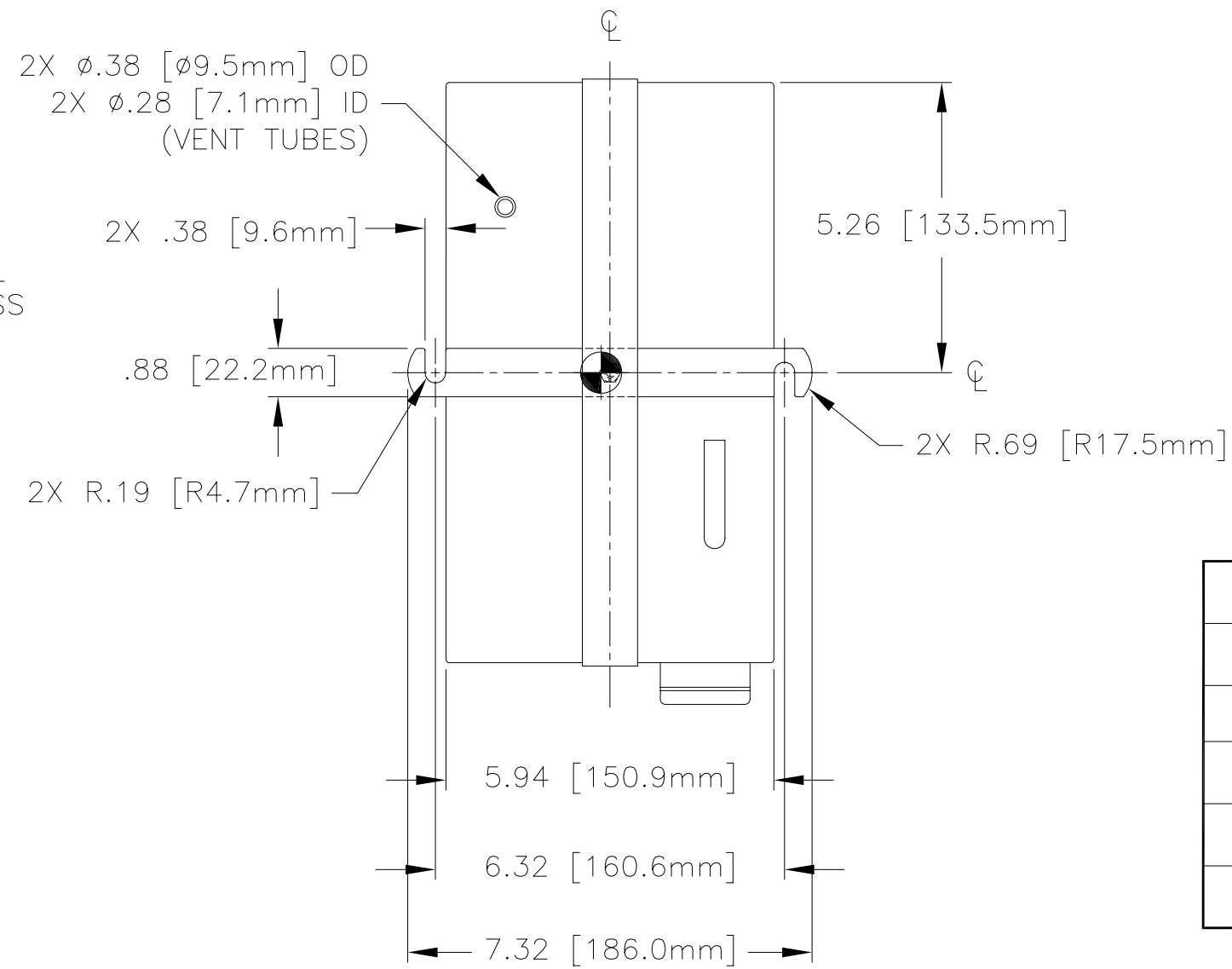

PART NUMBER	RG-206
MAXIMUM WEIGHT	42 LBS [19.1 KG]
RATED CAPACITY, C <sub>1</sub>	17 AH
POWER RATING AT 23°C	I <sub>pp</sub> 900 A, I <sub>pr</sub> 625 A
POWER RATING AT -18°C	I <sub>pp</sub> 600 A, I <sub>pr</sub> 425 A
POWER RATING AT -30°C	I <sub>pp</sub> 450 A, I <sub>pr</sub> 300 A

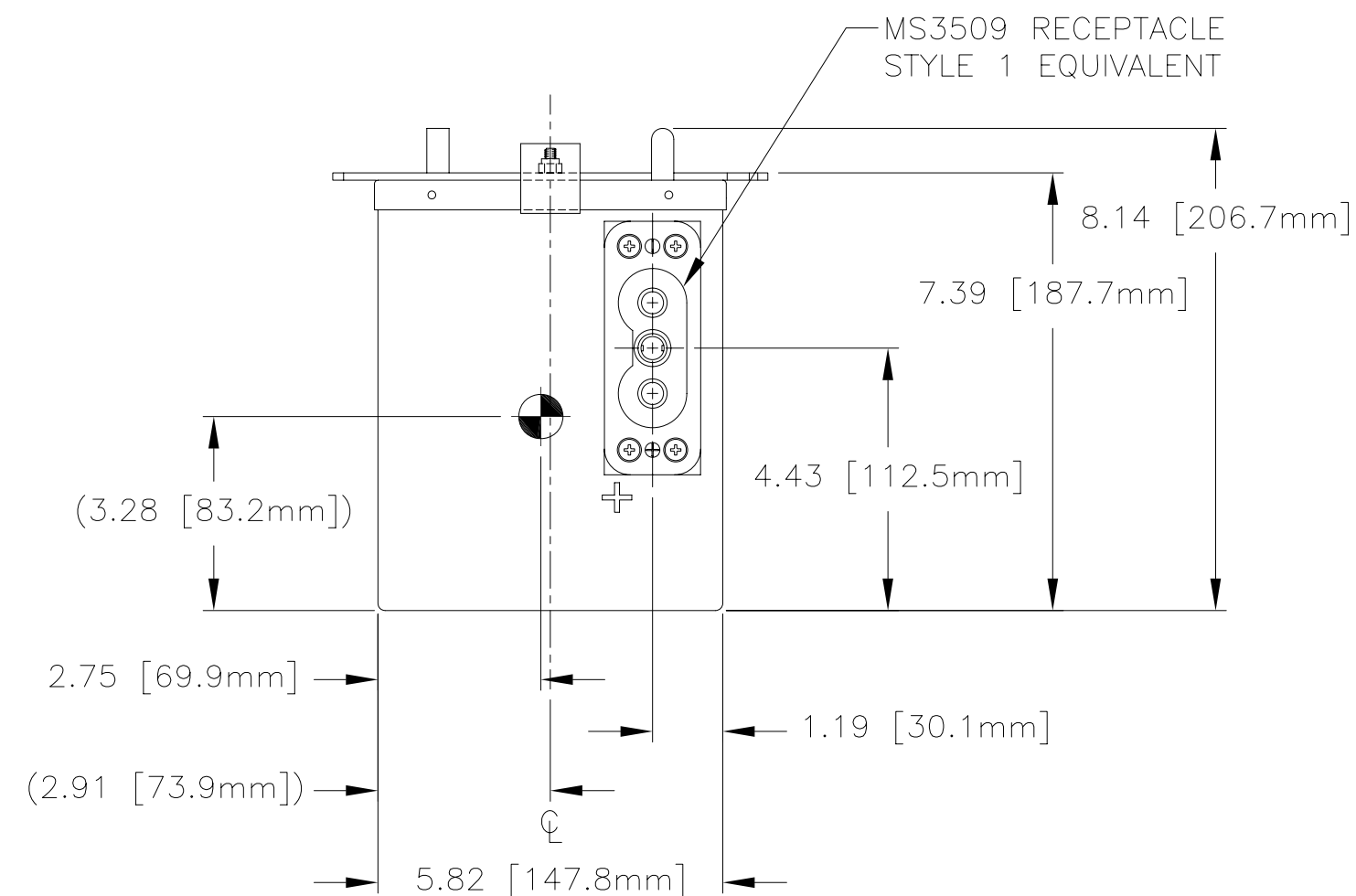
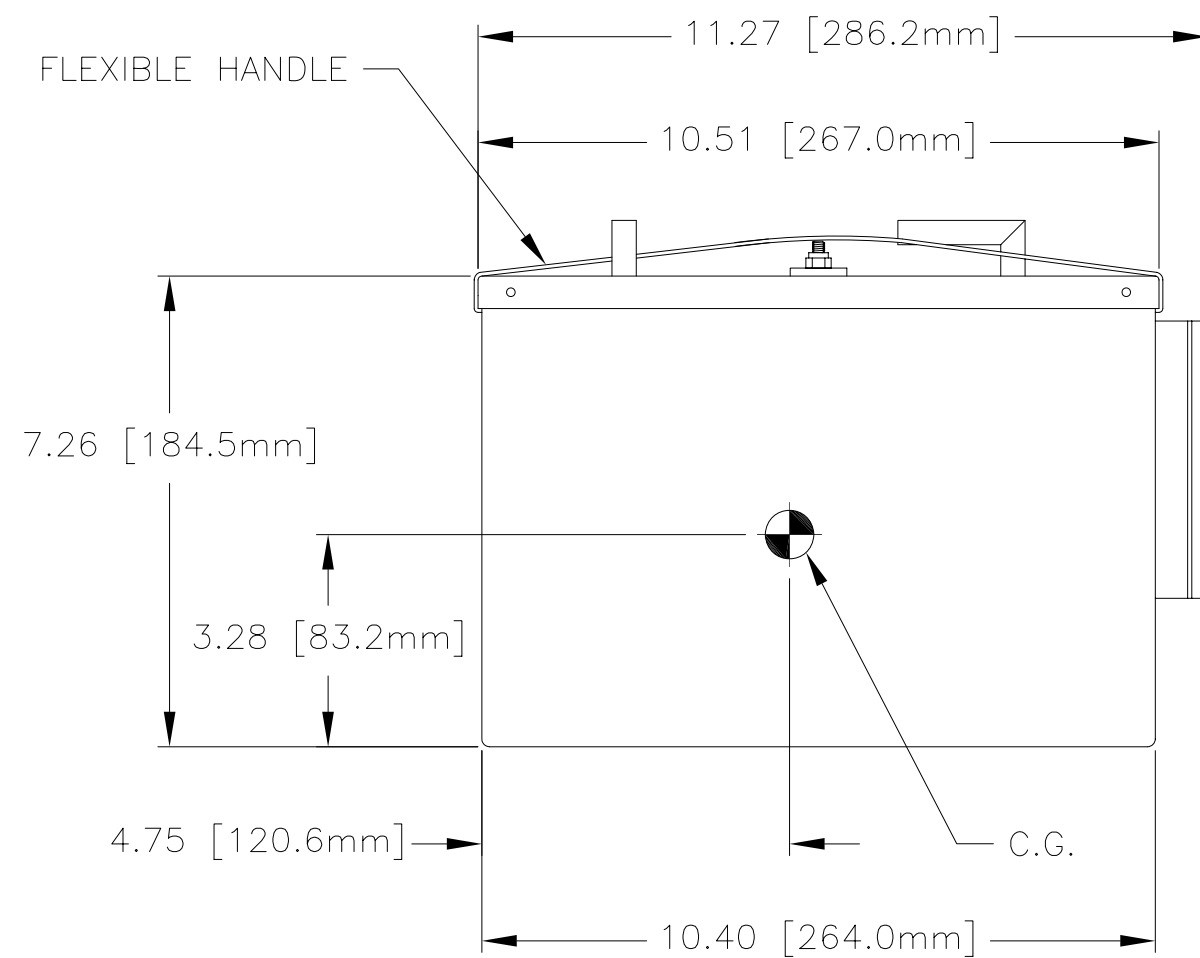

ENVELOPE DRAWING

QTY REQD	CAGE CODE	PART OR IDENTIFYING NO.	NOMENCLATURE OR DESCRIPTION	MATERIAL SPECIFICATION	ITEM NO.
PARTS LIST					
UNLESS OTHERWISE SPECIFIED DIMENSIONS ARE IN INCHES TOLERANCES ARE: FRACTIONS DECIMALS ANGLES ± 1/32 .XX ± .06 ± 1'			CONCORDE BATTERY CORPORATION 2009 SAN BERNARDINO RD, W. COVINA, CA 91790		
TREATMENT		APPROVALS		DATE	
NONE		DRAWN MENDOZA		1/26/95	
FINISH		CHECKED		DATE	
NONE		MK		1/30/95	
SIMILAR TO		APPROVED		DATE	
		DG		1/30/95	
ACT WT		ISSUED		SCALE	
CALC WT		JJ		NONE	
		11/9/09		CAGE CODE 63017	
				DWG NO. RG-206	
				REV E	
				SHEET 1 OF 1	